

1	1J3-25850-22-00	MASTER CYLINDER ASS'Y, front.	1
2	1J3-W0041-20-00	. CYLINDER KIT, master (1J3-20000-40).	1
3	1J3-25852-01-00	. CAP, reservoir front.	1
4	98706-05040-00	. SCREW, flat head	4
5	1J3-25854-01-00	. DIAPHRAGM, reservoir.	1
6	1J3-25855-01-00	. BUSHING, diaphragm.	1
7	1J3-25867-00-00	BRACKET, master cylinder.	1
8	97313-06025-00	BOLT, hexagon (97323-06025)	2
9	92903-06100-00	WASHER, spring.	2
10	2J2-83922-00-00	LEVER, right.	1
11	90149-06131-00	SCREW.	1
12	90170-06010-00	NUT (306-83927-00).	1
13	90501-10312-00	SPRING (306-83924-00).	1
14	90109-06465-00	BOLT.	1
15	95601-06100-00	NUT, U.	1
16	90401-10034-00	BOLT, union.	4
17	90201-10118-00	WASHER.	11
18	1T4-25872-01-00	HOSE, brake 1.	1
19	306-25862-00-00	BOOT, master cylinder.	1
20	1J7-25885-01-00	JOINT.	1
21	97301-06025-00	BOLT, hexagon.	1
22	92903-06100-00	WASHER, spring (92901-06100).	1
23	92901-06600-00	WASHER, plate.	1
24	1J7-25873-01-00	HOSE, brake 2.	2
25	90401-10044-00	BOLT, union.	1
26	1J7-25875-00-00	HOLDER, brake hose right.	1
27	1J7-25876-00-00	HOLDER, brake hose left.	1
28	1A0-83980-30-00	FRONT STOP SWITCH ASS'Y.	1
29	1T5-26372-00-00	COVER, brake lever.	1



Minimum Brake Lining Thickness

Front: 6.0mm

Rear: 6.0mm

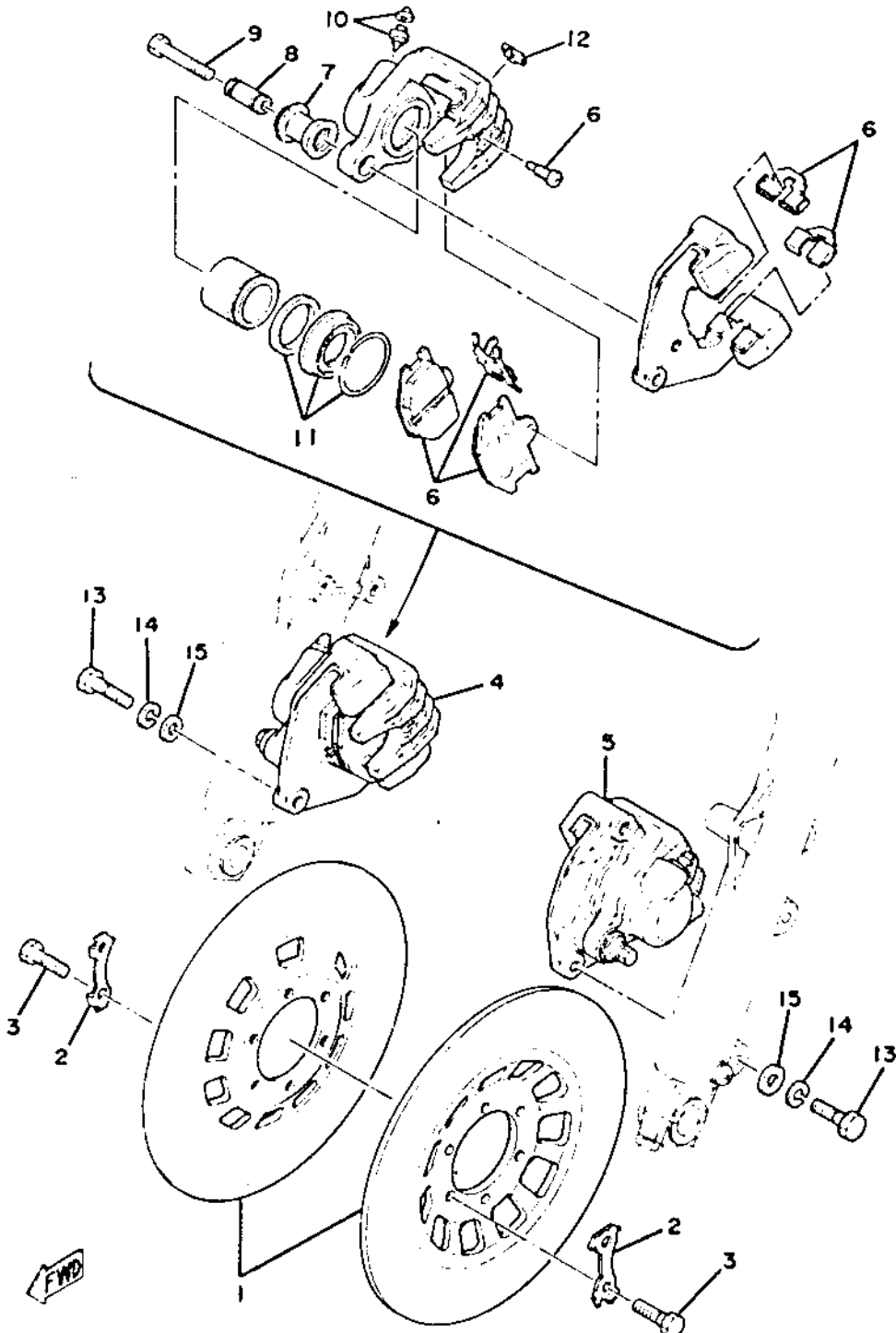

Ref. No.	Part Number	Description	Qty.
1	1J3-25831-50-00	DISC, front brake	2
2	1J3-25834-01-00	WASHER, lock	6
3	90101-08312-00	BOLT, hexagon	12
4	1J3-25810-04-00	FRONT CALIPER ASS'Y, right (1J3-25810-03)	1
5	1J3-25810-14-00	FRONT CALIPER ASS'Y, left (1J3-25810-13)	1
6	1J3-W0045-00-00	CALIPER PAD KIT	2
7	1J3-25917-00-00	BUSHING, boot	2
8	1J3-25838-00-00	SLEEVE	2
9	90105-08092-00	BOLT, support	2
10	1J3-W0048-00-00	SCREW, bleed with cap	2
11	1J3-20000-20-00	CALIPER SEAL KIT	2
	1J3-W0047-00-00	CALIPER SEAL KIT (1J3-20000-20)	2
12	1J3-25845-01-00	CAP, indicator	2
13	90101-10308-00	BOLT, hexagon	4
14	92903-10100-00	WASHER, spring (92901-10100)	4
15	92903-10200-00	WASHER, plate (92901-10200)	4