

CRANKCASE COVER

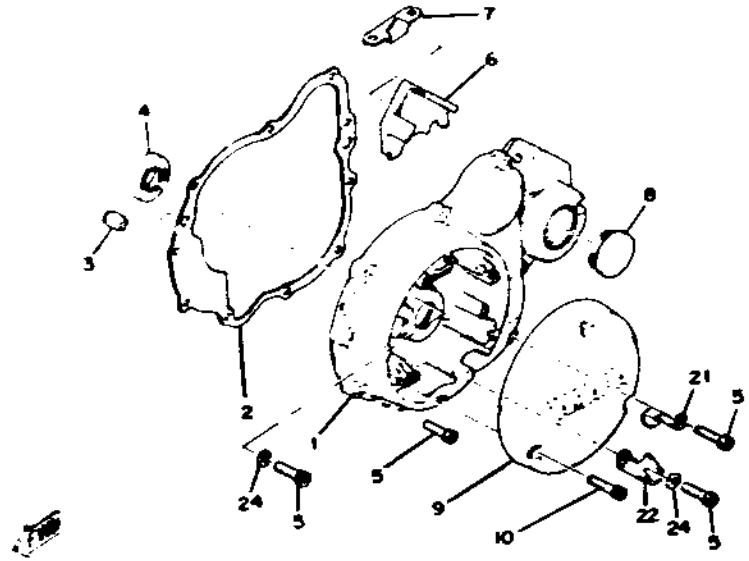
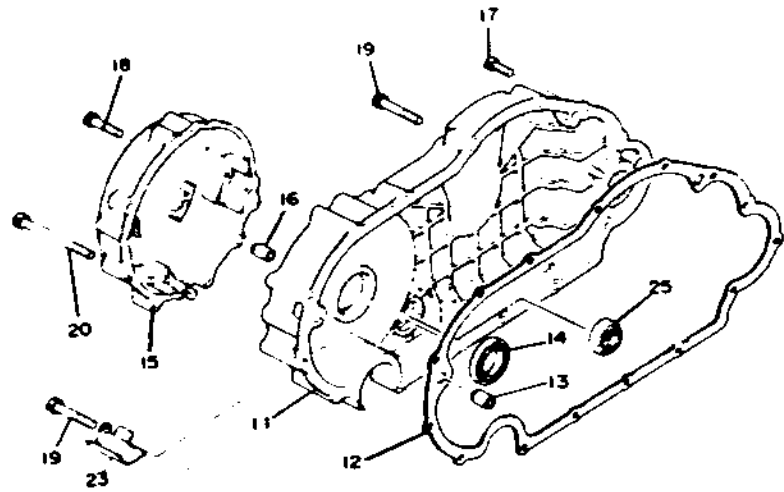

Ref. No.	Part Number	Description	Qty.	Remarks
* 1	1J7-15410-01-00	CRANKCASE COVER ASS'Y, left (1J7-15410-00)	1	
2	1J7-15461-00-00	GASKET, crankcase cover left	1	
3	91830-21014-00	PIN, dowel (8.5-10-15)	2	
4	93102-24154-00	OIL SEAL (SD-24-40-7.4)	1	
5	91316-06025-00	BOLT, hexagon socket head	11	
6	1J7-15474-00-00	SEAL, air dust	1	
7	1J7-15497-00-00	PLATE, dust seal	1	
8	1J7-15417-02-00	COVER, cap	1	
9	1J7-15416-00-00	COVER, breaker plate	1	
10	91316-06030-00	BOLT, hexagon socket head	3	
11	1J7-15431-10-00	COVER, crankcase right	1	
12	1J7-15451-00-00	GASKET, crankcase cover right	1	
13	91830-21014-00	PIN, dowel (8.5-10-14)	2	
	2F3-00000-20-00	GASKET KIT		See Grid H-1 for Kit Component Part
14	93102-25153-00	OIL SEAL (SD-25-40-6)	1	
15	1J7-15415-01-00	COVER, generator	1	
16	91310-18016-00	PIN, dowel (6.4-8-16)	2	
17	91316-06018-00	BOLT, hexagon socket head	4	
18	91316-06030-00	BOLT, hexagon socket head	1	
19	91316-06040-00	BOLT, hexagon socket head	7	
20	91316-06080-00	BOLT, hexagon socket head	4	
21	90465-08116-00	CLAMP (1J7-81628-00)	2	
22	1T4-81624-00-00	CLAMP	1	
23	90465-10113-00	CLAMP (1J7-81665-01)	1	
24	90201-06431-00	WASHER, plate (6.2-11-1.0)	2	
25	2H7-15361-00-00	GAUGE, oil level	1	

* Indicates new part numbers activated from January, 1981.