

MIDDLE DRIVE GEAR

Ref. No.	Part Number	Description	Qty.	Rem.
----------	-------------	-------------	------	------

Please take notice of the following points, when you place an order for the parts of MIDDLE DRIVE GEAR and FINAL DRIVE GEAR sections.

- Two kinds of parts are applied to both sections.
 TYPE I YG0-00000-00-0G
 TYPE II 1J7-00000-Y0-(N0) or 90000-00000
- Discrimination for these two types can be provided with the marking of "YAMAHA" displayed on TYPE II parts at the arrow "↙" marking section, but TYPE I parts do not have the marking of "YAMAHA".

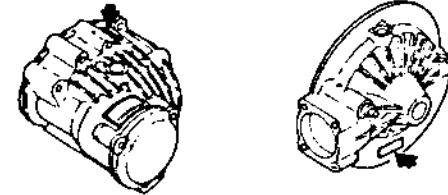

1	1J7-17501-N1-00	MIDDLE GEAR CASE ASS'Y (YG4-11000-22-0G).....	1	
2	YG4-11011-00-1G	HOUSING, middle gear.....	1	
	99999-01013-00	HOUSING, middle gear (1J7-17511-Y1).....	1	
	2H9-17511-00-00	HOUSING, middle gear.....	1	
	1J7-17551-Y1-00	HOUSING, bearing.....	1	
	93210-71360-00	O-RING.....	1	
	90201-08675-00	WASHER, plate.....	3	
3	93210-63847-00	O-RING (3-68) (YG9-00042-66-1G).....	1	
4	YG4-11011-10-0G	HOUSING, bearing.....	1	
	1J7-17521-Y0-00	HOUSING, bearing.....	1	
5	1J7-17519-Y0-00	GASKET, housing cap (YG4-11005-40-0G).....	1	
6	93306-30520-00	BEARING (6305 RB1) (YG9-00980-27-1G).....	1	

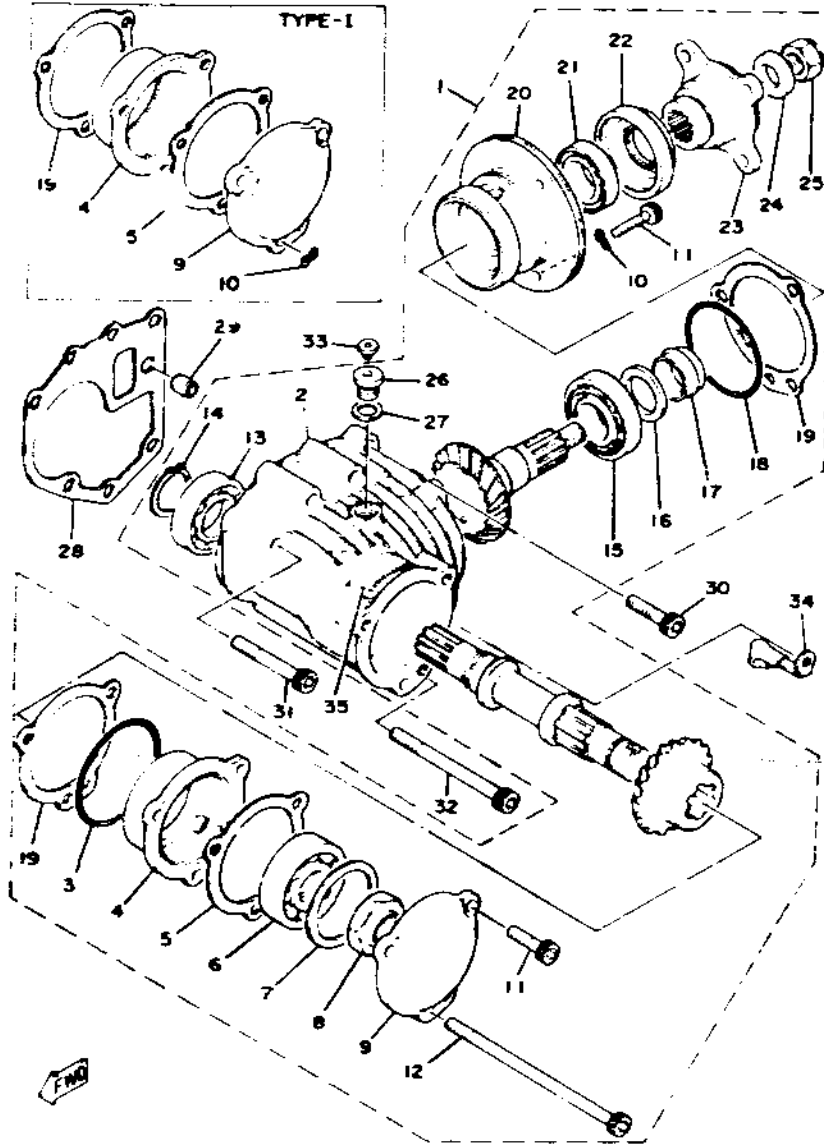

MIDDLE DRIVE GEAR

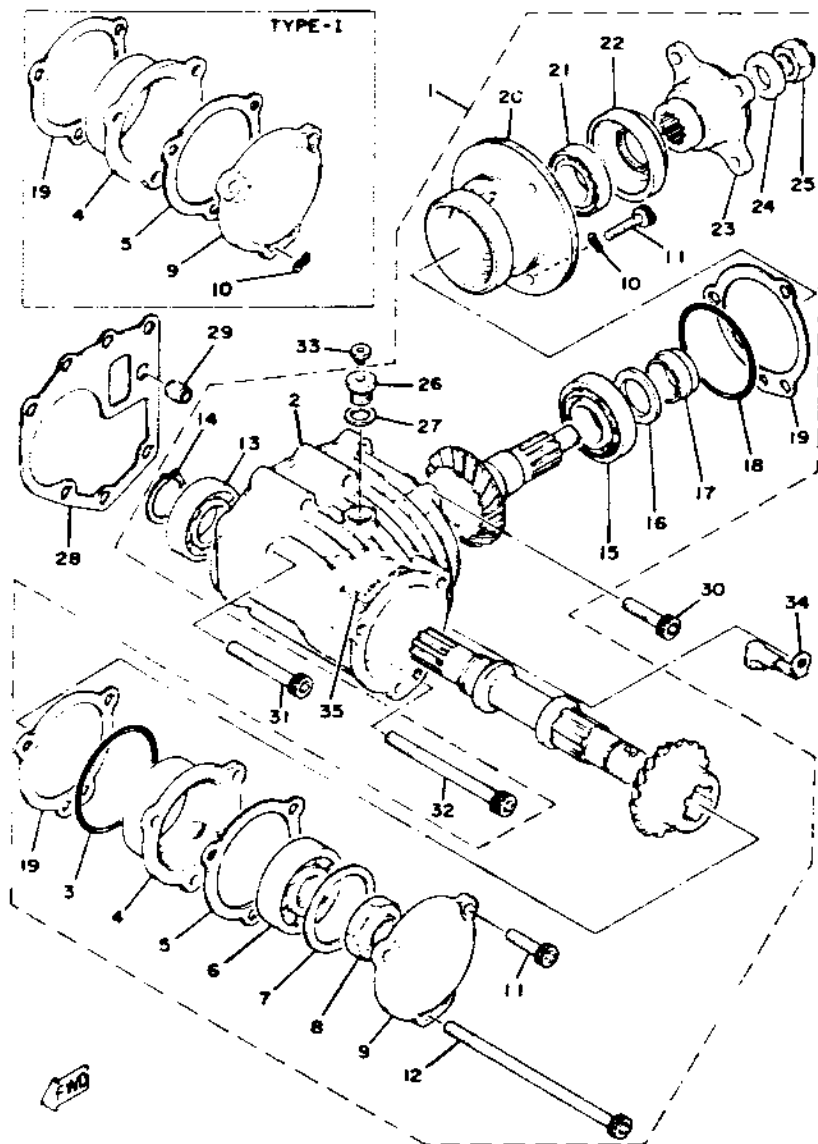

Ref. No.	Part Number	Description	Qty.	Remarks
7	1J7-17537-Y0-15	SHIM, thrust (50-62-0.15) (YG9-00026-14-4G)	1	U.R.
	1J7-17537-Y0-30	SHIM, thrust (50-62-0.3) (YG9-00009-34-4G)	1	U.R.
	1J7-17537-Y0-40	SHIM, thrust (50-62-0.4) (YG9-00020-34-4G)	1	U.R.
	1J7-17537-Y0-50	SHIM, thrust (50-62-0.5) (YG9-00009-44-4G)	1	U.R.
8	90179-24230-00	NUT (YG9-00000-22-9G)	1	M24-P1.5
9	1J7-17538-01-00	CAP, housing	1	TYPE I
	1J7-17538-Y1-00	CAP, housing	1	TYPE II
10	92901-08700-00	WASHER, wave (YG9-00014-84-1G)	6	
11	91316-08030-00	BOLT, hexagon socket head	5	M8-30L
12	91316-08160-00	BOLT, hexagon socket head (YG9-00920-71-1G)	1	M8-160L
13	93306-00608-00	BEARING (6006C3) (YG9-00913-37-1G)	1	
14	93410-30012-00	CIRCLIP (S-30) (YG9-00006-35-1G)	1	
15	93332-00022-00	BEARING, tapered roller (YG9-00930-37-3G)	1	
16	90201-25634-00	WASHER, plate (25.4-37-6) (YG4-11709-90-0G)	1	
17	1J7-17571-Y0-00	SPACER, expansion (YG4-11710-60-0G)	1	
18	93210-63847-00	O-RING (3-68) (YG9-00042-66-1G)	1	

MIDDLE DRIVE GEAR

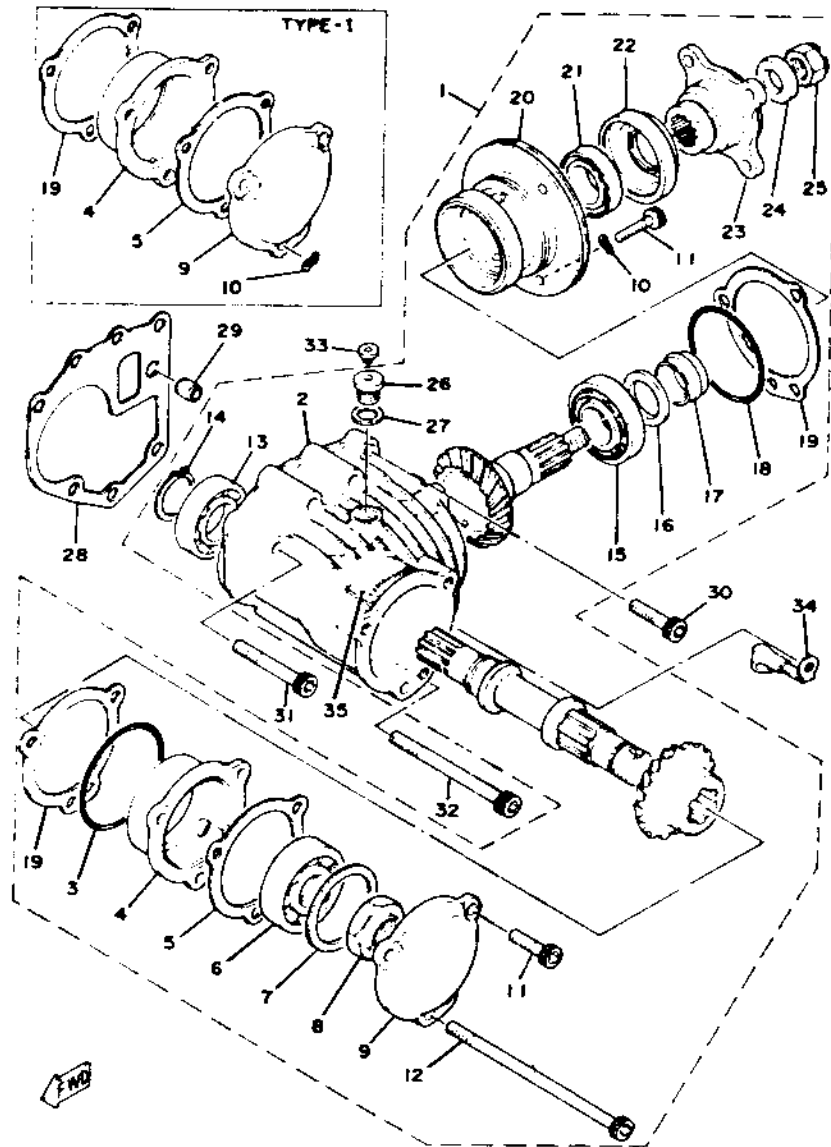

Ref. No.	Part Number	Description	Qty.	Remarks
19	YG4-11710-70-0G	SHIM, pinion (0.10)	2	U.R.
	1J7-17531-Y0-10	SHIM, pinion (0.10)	2	U.R.
	YG4-11708-90-0G	SHIM, pinion (0.15)	2	U.R.
	1J7-17531-Y0-15	SHIM, pinion (0.15)	2	U.R.
	YG4-11707-70-0G	SHIM, pinion (0.30)	2	U.R.
	1J7-17531-Y0-30	SHIM, pinion (0.30)	2	U.R.
20	1J7-17551-Y0-00	HOUSING, bearing (YG4-11011-40-0G)	1	
21	93332-00023-00	BEARING, tapered roller (YG9-00906-17-3G)	1	
22	93101-35085-00	OIL SEAL (S-35-63-16.5) (YG9-00930-76-0G)	1	
23	1J7-17555-Y0-00	FLANGE, middle gear (YG4-11706-50-1G)	1	
24	90201-14633-00	WASHER, plate (14.1-32-5) (YG4-11709-40-0G)	1	
25	90185-14070-00	NUT, self-locking (YG9-00001-62-7G)	1	M14-P1.5
26	90340-14046-00	PLUG, oil inlet (YG9-00006-61-5G)	1	
27	214-11198-01-00	GASKET (YG9-00027-26-2G)	1	
28	1J7-17518-00-00	GASKET, middle gear case	1	
29	91830-21014-00	PIN, dowel (6.4-10-14) (91810-02014)	1	
30	91316-08035-00	BOLT, hexagon socket head	1	
31	91316-08060-00	BOLT, hexagon socket head	3	
32	91316-08100-00	BOLT, hexagon socket head	2	
33	341-23469-00-00	CAP, plug	1	
34	90465-10137-00	CLAMP, harness	1	
35	1J7-46181-11-00	LABEL, oil caution (1J7-46181-10)	1	