

VALVE

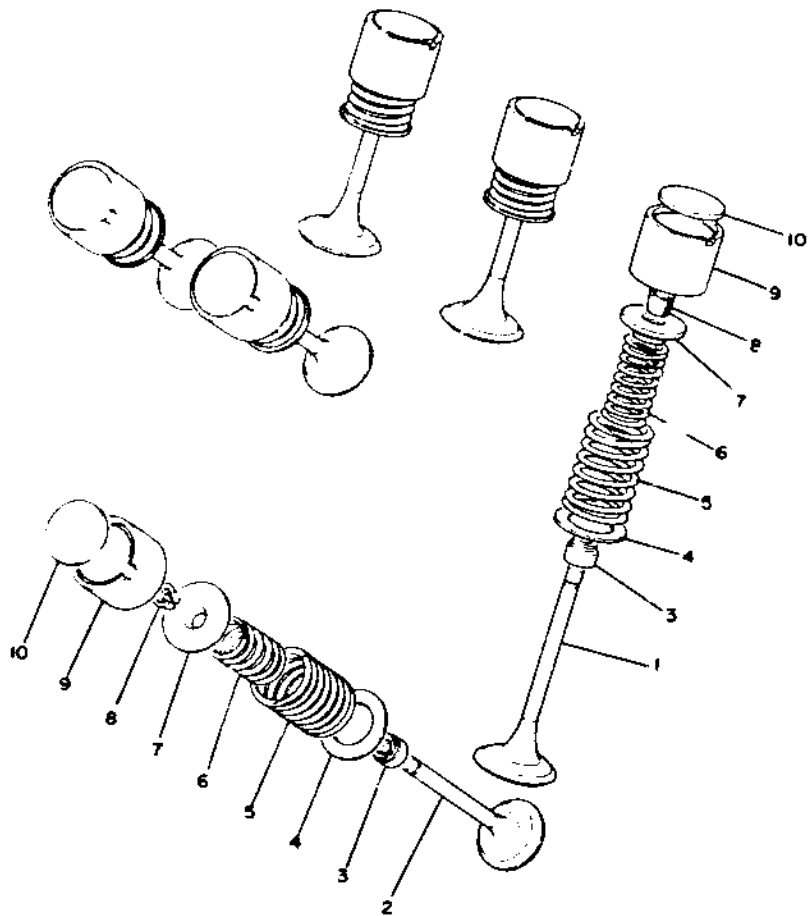

Ref. No.	Part Number	Description	Qty.
1	1J7-12111-01-00	VALVE, intake (1J7-12111-00)...	3
2	1J7-12121-00-00	VALVE, exhaust	3
3	1J7-12119-01-00	SEAL, valve stem oil	6
4	1J7-12116-00-00	SEAT, valve spring	6
5	90501-39414-00	SPRING, outer	6
6	90501-28415-00	SPRING, inner	6
7	2F3-12117-00-00	RETAINER, valve spring	6
8	1J7-12118-00-00	LOCK, valve spring retainer	12
9	1J7-12153-00-00	LIFTER, valve	6

VALVE

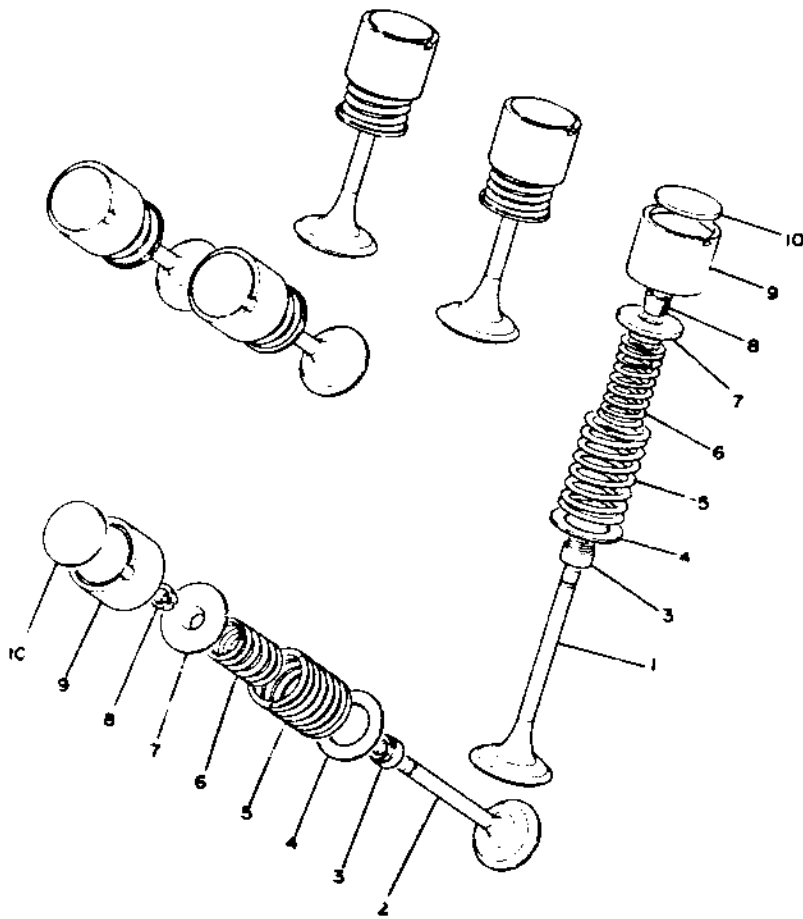

Ref. No.	Part Number	Description	Qty.
10	1J7-12169-01-00	PAD, adjusting (2.00)	6
	1J7-12169-11-00	PAD, adjusting (2.05)	6
	1J7-12169-21-00	PAD, adjusting (2.10)	6
	1J7-12169-31-00	PAD, adjusting (2.15)	6
	1J7-12169-41-00	PAD, adjusting (2.20)	6
	1J7-12169-51-00	PAD, adjusting (2.25)	6
	1J7-12169-61-00	PAD, adjusting (2.30)	6
	1J7-12169-71-00	PAD, adjusting (2.35)	6
	1J7-12169-81-00	PAD, adjusting (2.40)	6
	1J7-12169-91-00	PAD, adjusting (2.45)	6
	1J7-12169-A1-00	PAD, adjusting (2.50)	6
	1J7-12169-E1-00	PAD, adjusting (2.55)	6
	1J7-12169-F1-00	PAD, adjusting (2.60)	6
	1J7-12169-G1-00	PAD, adjusting (2.65)	6
	1J7-12169-H1-00	PAD, adjusting (2.70)	6
	1J7-12169-J1-00	PAD, adjusting (2.75)	6
	1J7-12169-K1-00	PAD, adjusting (2.80)	6
	1J7-12169-L1-00	PAD, adjusting (2.85)	6
	1J7-12169-M1-00	PAD, adjusting (2.90)	6
	1J7-12169-N1-00	PAD, adjusting (2.95)	6
	1J7-12169-R1-00	PAD, adjusting (3.00)	6
	1J7-12169-T1-00	PAD, adjusting (3.05)	6
	1J7-12169-U1-00	PAD, adjusting (3.10)	6
	1J7-12169-V1-00	PAD, adjusting (3.15)	6
	1J7-12169-W1-00	PAD, adjusting (3.20)	6