

| Ref. No. | Part Number | Description | Qty. |
|----------|-----------------|---|------|
| 1 | 3J2-11110-00-00 | CYLINDER HEAD ASS'Y | 1 |
| 2 | 93603-09004-00 | . PIN, dowel | 4 |
| 3 | 90116-06228-00 | . BOLT, stud | 16 |
| 4 | 92901-06600-00 | . WASHER, plate | 16 |
| 5 | 95301-06600-00 | . NUT | 16 |
| 6 | 93210-11313-00 | . O-RING | 6 |
| 7 | 1J7-11133-10-00 | . GUIDE, intake valve (1st O/S) | 3 |
| 8 | 1J7-11134-10-00 | . GUIDE, exhaust valve (1st O/S) | 3 |
| 9 | 1J7-12173-10-00 | . CAP, camshaft 1 | 2 |
| 10 | 1J7-12183-10-00 | . CAP, camshaft 2 | 6 |
| 11 | 90116-08161-00 | BOLT, stud | 2 |
| 12 | 90116-08271-00 | BOLT, stud | 6 |
| 13 | 434-11161-00-00 | ABSORBER 1 | 19 |
| 14 | 90201-10124-00 | WASHER, plate | 6 |
| 15 | 90201-11597-00 | WASHER, plate | 2 |
| 16 | 90179-10277-00 | NUT | 8 |
| 17 | 90201-08382-00 | WASHER, plate | 2 |
| 18 | 97321-08045-00 | BOLT | 2 |
| 19 | 94701-00117-00 | PLUG, spark (NGK BP-7ES) | 3 |
| | 94701-00135-00 | PLUG, spark (Champion N-7Y) ... | 3 |
| 20 | 3J2-11181-02-00 | GASKET, cylinder head 1 (3J2-11181-00) | 1 |

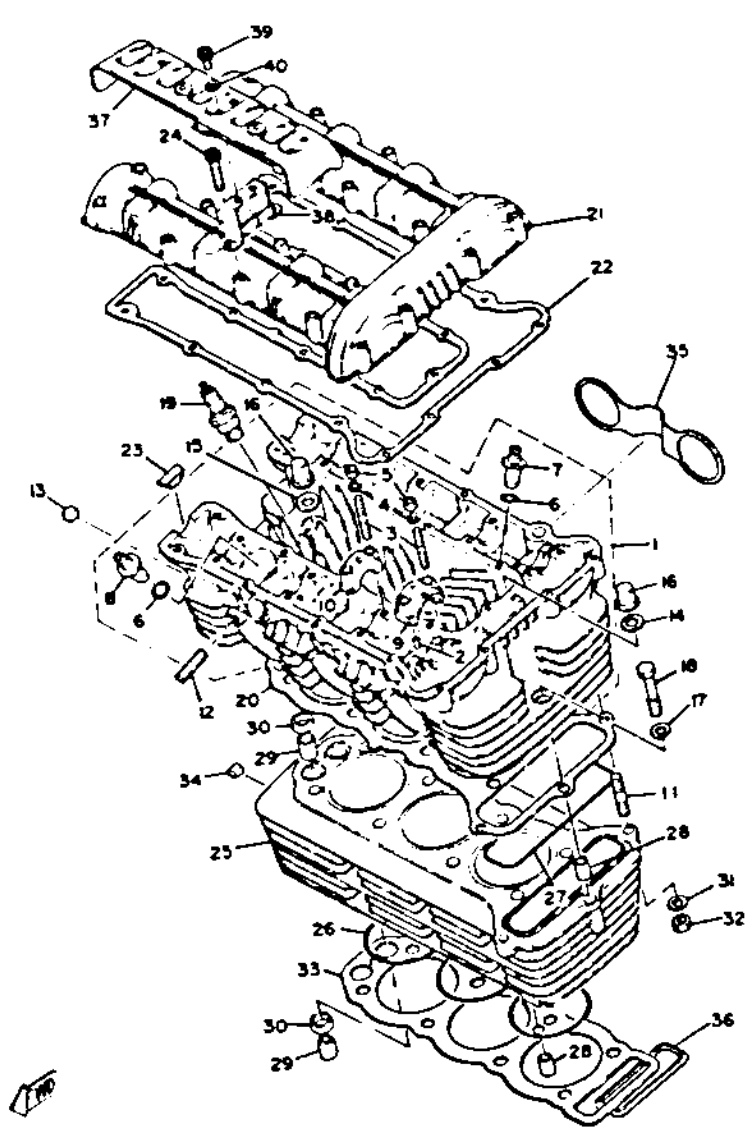

| No. | Number | Description | Qty. |
|-----|-----------------|-----------------------------|------|
| 21 | 2G2-11191-00-00 | COVER, cylinder head 1..... | 1 |
| 22 | 1J7-11193-00-00 | GASKET, head cover 1..... | 1 |
| 23 | 2G2-11138-00-00 | PLUG..... | 2 |
| 24 | 91311-06035-00 | BOLT..... | 21 |
| 25 | 3J2-11310-00-00 | CYLINDER..... | 1 |
| 26 | 93210-77363-00 | O-RING..... | 3 |
| 27 | 1J7-11355-00-00 | SEAL, cylinder 1..... | 1 |
| 28 | 91810-03014-00 | PIN, dowel..... | 2 |
| 29 | 91830-24016-00 | PIN, dowel..... | 2 |
| 30 | 1J7-11357-00-00 | SEAL, cylinder 3..... | 2 |
| 31 | 90201-08382-00 | WASHER, plate..... | 2 |
| 32 | 95311-08600-00 | NUT..... | 2 |
| 33 | 3J2-11351-00-00 | GASKET, cylinder..... | 1 |
| 34 | 434-11161-00-00 | ABSORBER 1..... | 10 |
| 35 | 90465-08120-00 | CLAMP..... | 1 |
| 36 | 3J2-11356-00-00 | SEAL, cylinder 2..... | 1 |
| 37 | 1J7-11192-03-00 | COVER, cylinder head 2..... | 1 |
| 38 | 1J7-11183-01-00 | BRACKET, camshaft 1..... | 3 |
| 39 | 91316-06014-00 | BOLT..... | 6 |
| 40 | 92906-06600-00 | WASHER, plate..... | 6 |

| | |
|--|--|
| ENGINE TYPE | 4-Stroke, DOHC, Air Cooled, Transverse Triple |
| Bore/Stroke/Number Cylinders/Displacement (cc) | 71.5mm / 68.6mm / 3 / 826cc |
| Compression Ratio/Compression Pressure Min~Max | 9.2: 1 / 9 ~ 11 kg/cm ² |
| Spark Plug Type | NGK BP-7ES or Champion N-7Y |
| Spark Plug Gap / Torque / Cap Ω | 0.7 ~ 0.8mm / 2.0 m·kg / 5K Ω \pm 20% |
| TORQUE VALUES | |
| Cylinder Head Cover | 6 x 1.0: 1.0 m·kg |
| Cylinder Head: | 10 x 1.25: 3.5 m·kg (Use Oil) |
| | 8 x 1.25: 2.3 m·kg (Use Oil) |