

1	1J7-24110-00-X3	FUEL TANK COMP.	1
2	2F3-24161-20-00	EMBLEM 1	2
3	3J3-24240-00-00	GRAPHIC SET	1
4	1J7-24181-01-00	DAMPER, locating 1	2
5	90201-13791-00	WASHER, plate	2
6	1J7-24182-01-00	DAMPER, locating 2	1
7	3J3-24183-00-00	DAMPER, locating 3	2
8	90209-08098-00	WASHER	1
9	97301-08012-00	BOLT	1
10	90445-10133-00	HOSE	2
11	90445-09489-00	HOSE	2
12	90467-09006-00	CLIP	4
13	3J3-24500-02-00	FUEL COCK ASS'Y 1 (3J3-24500-02)	1
14	2G2-24524-00-00	LEVER, cock	1
15	2G2-24523-00-00	VALVE	1
16	2G2-24518-00-00	WASHER, wave	1
17	2G2-24525-00-00	PLATE, lever fitting	1
18	98501-03008-00	SCREW, pan head	2
19	2G2-24534-00-00	O-RING	1
20	2G2-24512-00-00	O-RING	1
21	92501-06008-00	SCREW, pan head	1
22	2G2-24522-00-00	GASKET	1
23	2G2-24514-01-00	NET, filter 1	1

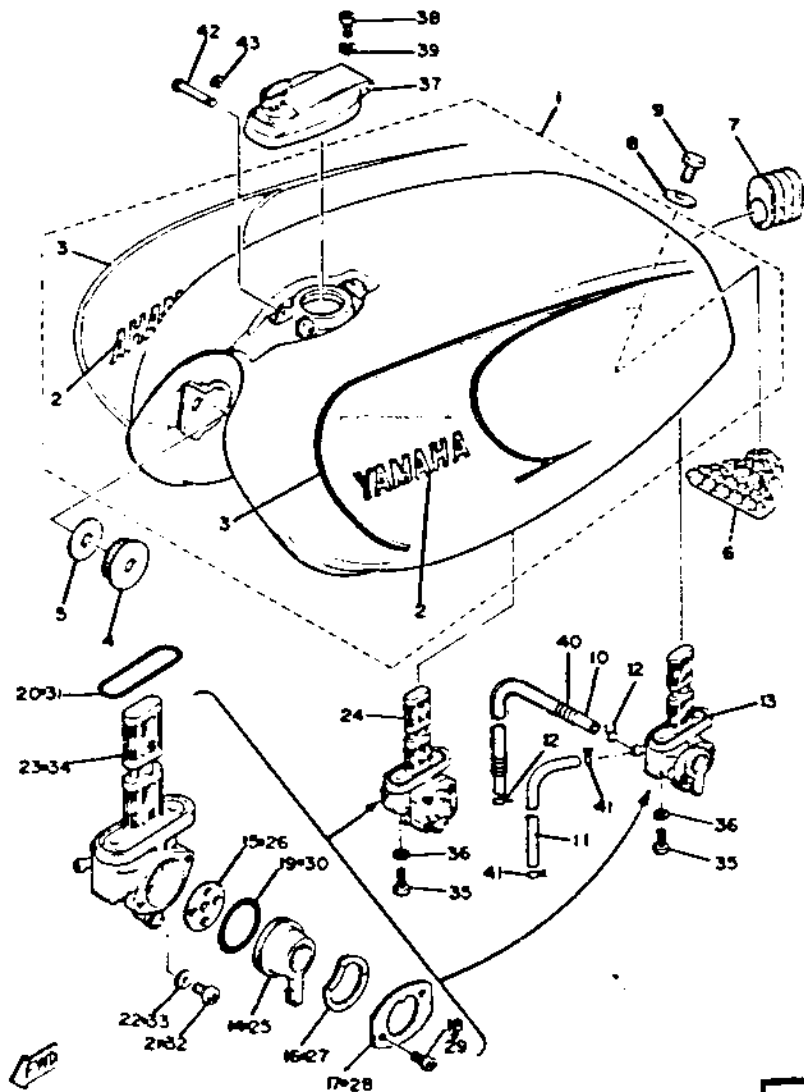

24	3J3-24510-02-00	FUEL COCK ASS'Y 2 (3J3-24510-00)	1
25	2G2-24524-10-00	LEVER, cock	1
26	2G2-24523-00-00	VALE	1
27	2G2-24518-00-00	WASHER, wave	1
28	2G2-24525-10-00	PLATE, lever fitting	1
29	98501-03008-00	SCREW, pan head	2
30	2G2-24534-00-00	O-RING	1
31	2G2-24512-00-00	O-RING	1
32	92501-06008-00	SCREW, pan head	1
33	2G2-24522-00-00	GASKET	1
34	2G2-24514-01-00	NET, filter 1	1
35	90149-06008-00	SCREW	4
36	90202-06010-00	WASHER, plate	4
37	584-24602-00-00	CAP ASS'Y	1
38	98501-05010-00	SCREW, pan head (98503-05008)	1
39	92903-05100-00	WASHER, spring (92901-05100)	1
40	90504-06023-00	SPRING, compression	2
41	90467-08003-00	CLIP	4
42	90249-03123-00	PIN	1
43	93430-02001-00	CIRCLIP (E-1.9)	1

Basic Color(s)	Black Blue (B)	New Ruby Red (R)
Fuel Type/Fuel Tank Capacity/Reserve Capacity	Regular / 17 Lit. (4.5 Gal.) / 3.0 Lit. (0.8 Ga	