

Ref No	Part Number	Description	Qty.
1	1T4-26111-00-00	HANDLEBAR	1
2	2H7-26241-00-00	GRIP (LH.)	1
3	2H7-26240-00-00	GRIP ASS'Y.	1
* 4	1T4-26311-01-00	CABLE, throttle 1	1
* 5	584-26393-02-00	HOLDER	1
6	3J3-26335-00-00	CABLE, clutch	1
7	90123-08046-00	BOLT	1
8	90179-08148-00	NUT	1
9	2H7-26290-10-00	MIRROR ASS'Y.	1
10	2H7-26290-00-00	MIRROR ASS'Y.	1
11	1J7-26399-00-00	GUIDE, cable	1
12	1T5-26372-00-00	COVER, handle lever	1
13	1E6-26372-00-00	COVER, handle lever	1
14	1E6-26342-00-00	BOOT, cable	1

*Indicates new part numbers activated from March, 1980

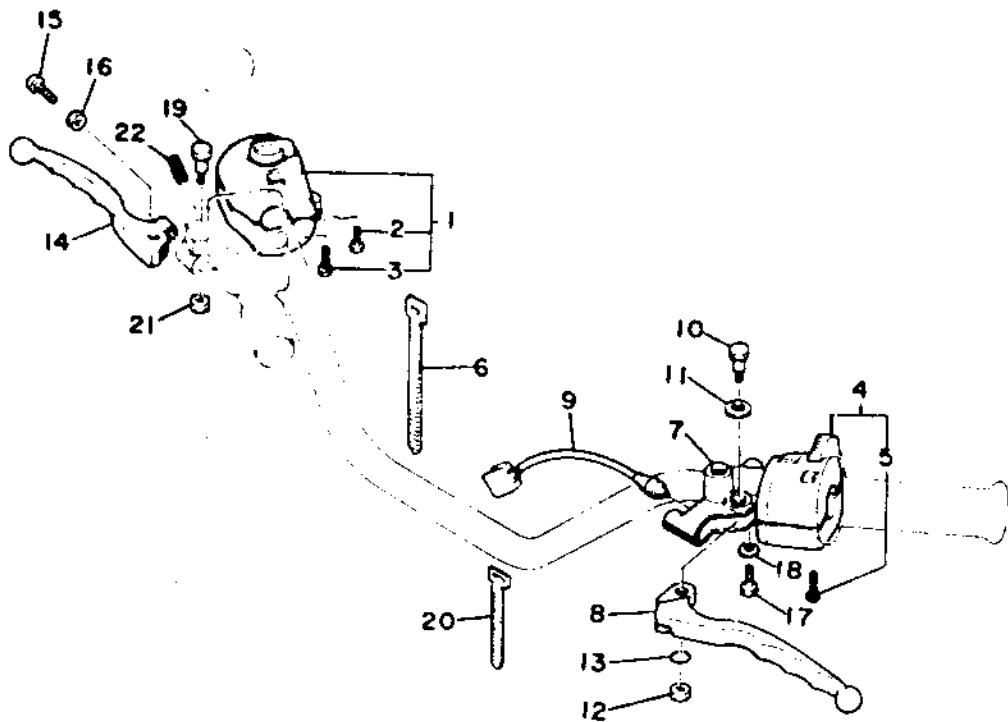

Ref No	Part Number	Description	Qty
1	2F3-83975-00-98	SWITCH, handle 2	1
2	98506-05030-00	SCREW, pan head	1
* 3	98506-05040-00	SCREW, pan head	1
4	1J7-83973-01-98	SWITCH, handle 3	1
5	98506-05030-00	SCREW, pan head	2
6	437-83936-00-00	BAND, switch cord	4
* 7	4K0-82911-00-00	HOLDER, lever 1	1
8	2H7-83912-00-00	LEVER 1	1
9	3Y6-82917-00-00	SWITCH	1
10	2H7-83945-00-00	BOLT, lever	1
11	90201-08083-00	WASHER, plate	1
12	95601-06100-00	NUT, U	1
13	93210-11368-00	O-RING	1
14	2J2-83922-00-00	LEVER 2	2
15	90149-06131-00	SCREW	1
16	90170-06010-00	NUT	1
17	97306-06022-00	BOLT	1
18	92906-06100-00	WASHER, spring	1
19	90109-06465-00	BOLT	1
20	341-26397-01-00	BAND	2
21	95601-06100-00	NUT, U	1
22	90501-10312-00	SPRING, compression	1

*Indicates new part numbers activated from March, 1980