

# VALVE

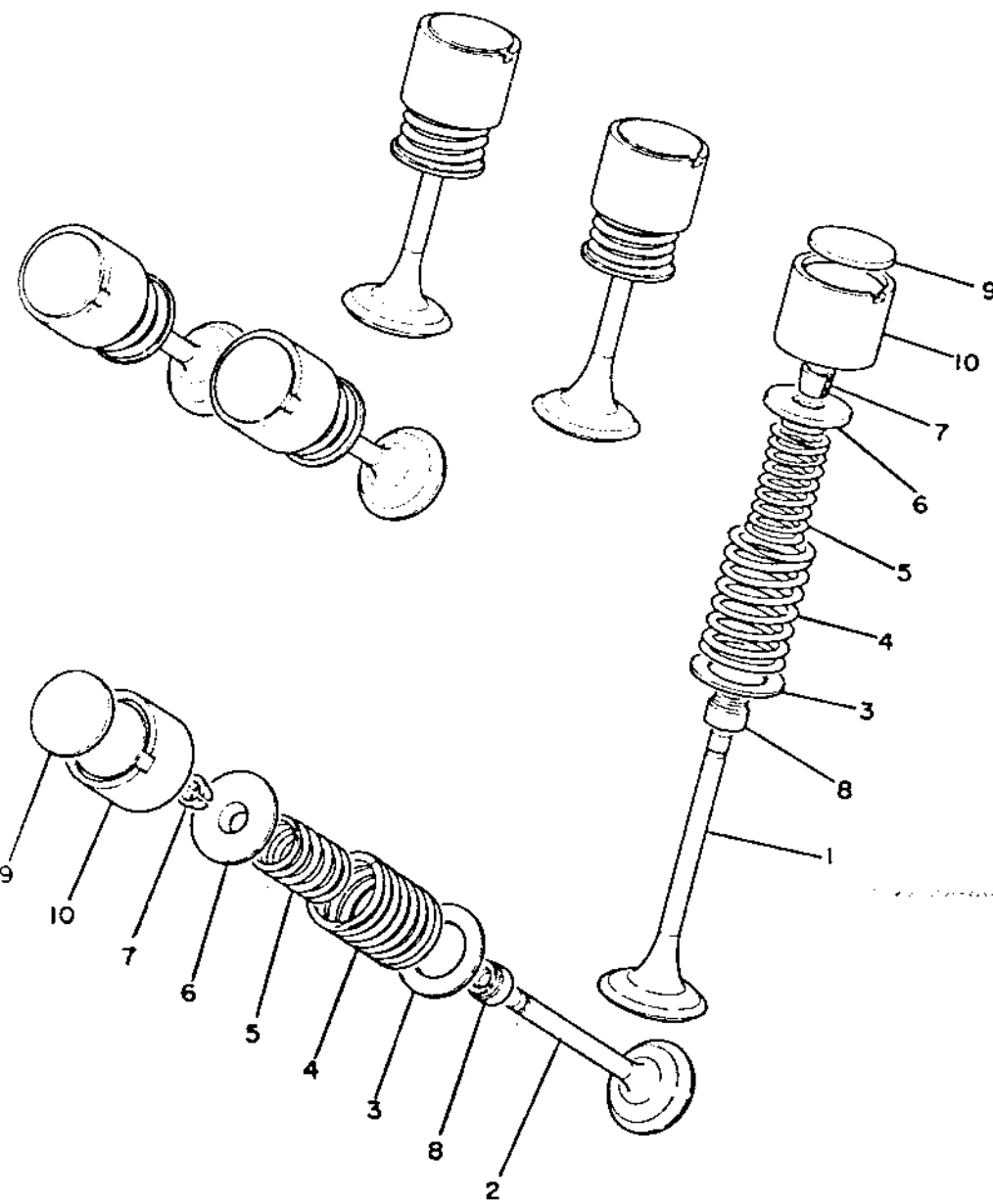

Ref. No.	Part Number	Description	Qty.	Applicable Machine No
* 1	1J7-12111-01-00	VALVE, intake	3	
2	1J7-12121-00-00	VALVE, exhaust	3	
3	1J7-12116-00-00	SEAT, valve spring	6	
4	90501-39414-00	SPRING, compression	6	
5	90501-28415-00	SPRING, compression	6	
6	2F3-12117-00-00	RETAINER, valve spring	6	
7	1J7-12118-00-00	COTTER, VALVE	12	
8	1J7-12119-01-00	SEAL, valve stem	6	
9	1J7-12169-01-00	PAD, adjusting (2.00)	6	U.R.
	1J7-12169-11-00	PAD, adjusting (2.05)	6	U.R.
	1J7-12169-21-00	PAD, adjusting (2.10)	6	U.R.
	1J7-12169-31-00	PAD, adjusting (2.15)	6	U.R.
	1J7-12169-41-00	PAD, adjusting (2.20)	6	U.R.
	1J7-12169-51-00	PAD, adjusting (2.25)	6	U.R.
	1J7-12169-61-00	PAD, adjusting (2.30)	6	U.R.
	1J7-12169-71-00	PAD, adjusting (2.35)	6	U.R.
	1J7-12169-81-00	PAD, adjusting (2.40)	6	U.R.
	1J7-12169-91-00	PAD, adjusting (2.45)	6	U.R.
	1J7-12169-A1-00	PAD, adjusting (2.50)	6	U.R.
	1J7-12169-E1-00	PAD, adjusting (2.55)	6	U.R.
	1J7-12169-F1-00	PAD, adjusting (2.60)	6	U.R.
	1J7-12169-G1-00	PAD, adjusting (2.65)	6	U.R.
	1J7-12169-H1-00	PAD, adjusting (2.70)	6	U.R.
	1J7-12169-J1-00	PAD, adjusting (2.75)	6	U.R.
	1J7-12169-K1-00	PAD, adjusting (2.80)	6	U.R.
	1J7-12169-L1-00	PAD, adjusting (2.85)	6	U.R.
	1J7-12169-M1-00	PAD, adjusting (2.90)	6	U.R.
	1J7-12169-N1-00	PAD, adjusting (2.95)	6	U.R.

FWD

Valve Clearance (Cold) Intake / Exhaust	0.11mm ~ 0.15mm / 0.21mm ~ 0.25mm
---	-----------------------------------

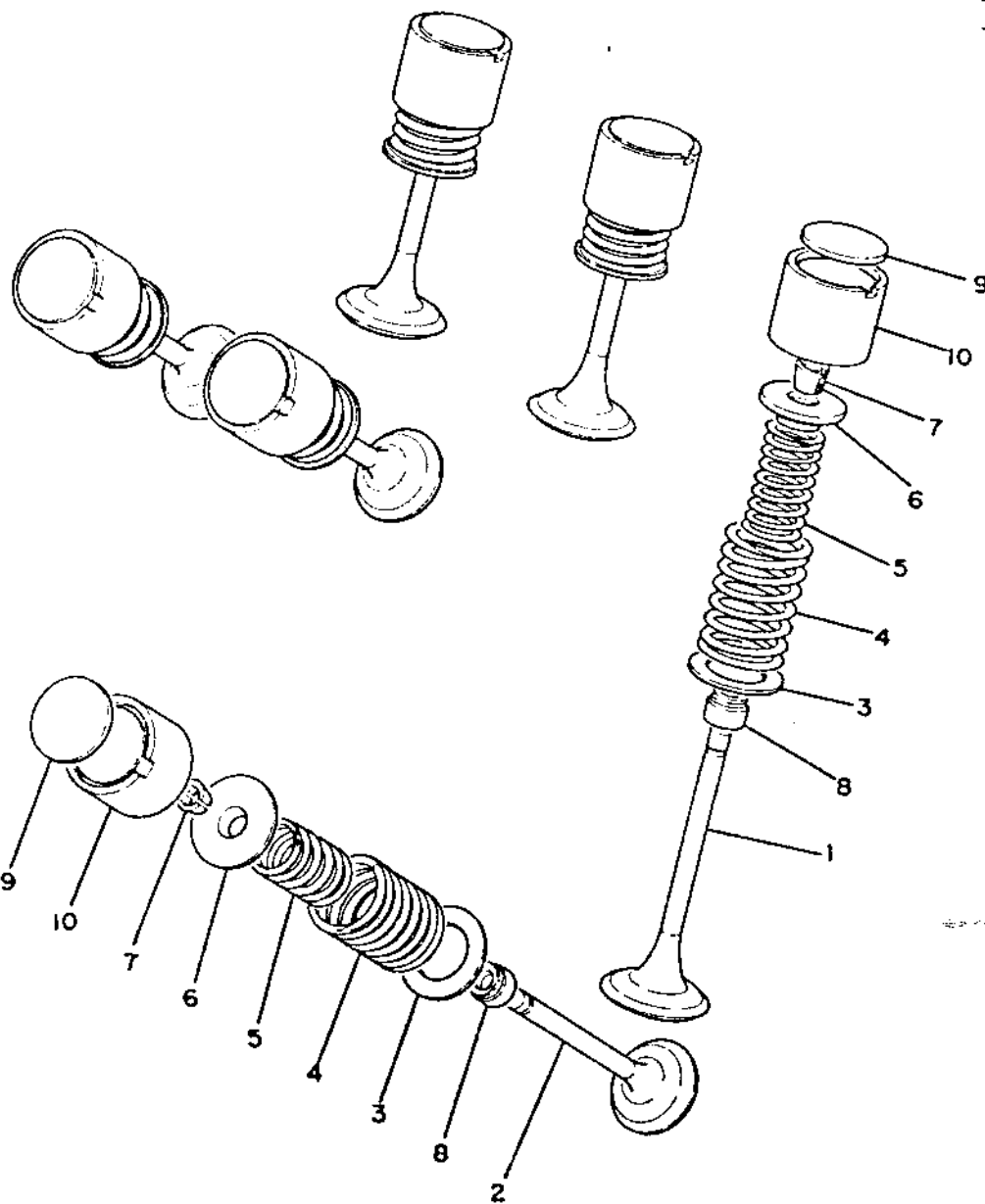

Ref. No.	Part Number	Description	Qty.	Ap Ma No
	1J7-12169-R1-00	PAD, adjusting (3.00).....	6	U.
	1J7-12169-T1-00	PAD, adjusting (3.05).....	6	U.
	1J7-12169-U1-00	PAD, adjusting (3.10).....	6	U.
	1J7-12169-V1-00	PAD, adjusting (3.15).....	6	U.
	1J7-12169-W1-00	PAD, adjusting (3.20).....	6	U.
10	4H7-12513-01-00	LIFTER, valve .....	6	



Valve Clearance (Cold) Intake / Exhaust	0.11mm ~ 0.15mm / 0.21mm ~ 0.25mm
---	-----------------------------------